

SKIDAWAY ISLAND

[Chatham County]
Phone: (800) 864-PARK

Set GPS to W81 0523333", N 31 942400°

TYPE: Public State Park. Handicap Access. pets welcome.

DIRECTIONS: good paved interior rds. good paved access rd. (East of town) From Jct of I-95 & SR-204 (Exit 94), E 10.6 mi on SR-204 to Spur 204, SE 6.8 mi on Spur 204 to park gate (L). Parking fee required. Email contact page on website.

SITES: 87 available: 87 gravel sites.no patios, mostly shaded, 14 day max stay, 87 pull-thrus (40 x 110), no Side-by-side hookups, 87 water, 87 electric (30/50 amps), cable services (minor). Table at site, BBQ at site, WiFi Hotspot.

FACILITIES: restrooms and showers, dumping station, public phone, laundry, firewood, library.

RECREATION: Pay pool, horseshoes, planned activities, playground, pavilion, nature trails.

OPEN: Open all year.

RATES: \$25 to \$28 (Last year's).

Visa, MasterCard, Discover, American Express, Debit Card.

Skidaway Island State Park



Legend

- Campground Host
- 30 Amp Campsite
- 50 Amp Campsite
- 50 Amp Sewer
- Camper Cabins
- Restrooms
- Showers
- Laundry
- Dump Station
- Handicap
- Parking
- Picnic Shelter
- Playground
- Camping
- Dumpsters
- Trails

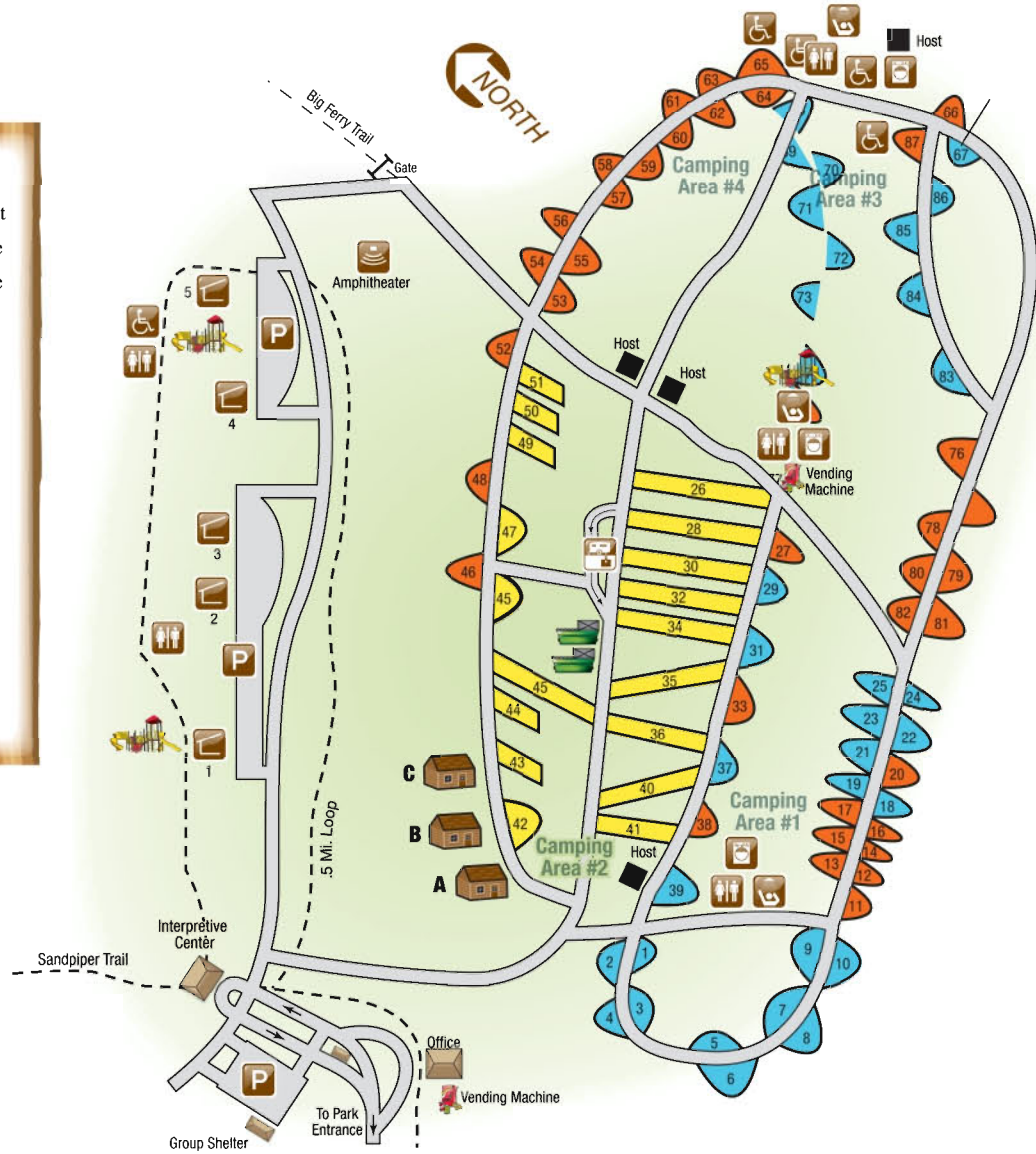

Skidaway Island State Park

52 Diamond Causeway, Savannah, GA 31411
 (912) 598-2300 • www.GaStateParks.org
 Chatham County

GEORGIA
 DEPARTMENT OF NATURAL RESOURCES
 STATE PARKS & HISTORIC SITES

Located near historic Savannah, this park borders Skidaway narrows, a part of Georgia's intracoastal waterway. The park provides camping and picnicking surrounded by Spanish moss-draped live oaks. Trails wind through maritime forest and over salt marsh allowing visitors to watch for deer, fiddler crabs, raccoons, egrets and migrating birds such as colorful painted buntings. An observation tower provides another chance to watch for wildlife on this barrier island. A giant ground sloth replica, birding station, reptile room, and natural and cultural exhibits are featured in the interpretive center. Most facilities are ADA accessible.



Cable TV

CHANNEL	STATION
2.....	ABC-WJCL
3.....	NBC-WSAV
4.....	CW-WGSA
5.....	FOX-WTGS
6.....	CBS-WTOC
7.....	PBS-GPB
8.....	Weather
9.....	CNN
10.....	TLC
11.....	TBS
12.....	TNT
13.....	USA
14.....	FX
15.....	Discovery
16.....	National Geographic
17.....	Cartoon Network
18.....	ESPN
19.....	ESPN2
20.....	ESPNEWS
21.....	ESPNU

Gate Code 1024



A Former Resident
 The Giant Ground Sloth lived here during the Ice Age. You can see him now at our Interpretive Center!

Wormsloe State Historic Site



The bearer of this coupon will receive \$2.00 off admission up to 6 people

Valid until July 31, 2014
 912-353-3023

Southeast Publications SINCE 1986
 SERVING USA & CANADA
 All Rights Reserved © 2013

Activities and Facilities

Camping — The park offers 70 pull through sites with water and electrical hook-ups and 17 sites that offer water, electrical and sewer hookups. ADA accessible campsite and restroom available. Elevated tent pads are provided along with a fire ring and table. Campfires are allowed and must be built in the fire rings provided on each campsite. Cable hook-ups at all sites. Three restrooms with hot showers and coin-operated washers and dryers.

Cabins — The park offers 3 camper cabins. Linens and kitchenware are not provided. Camper cabins have a queen size bed in a separate bedroom and sleeping loft suitable for 2 or 3 children. ADA accessible.

Picnicking — There are approximately ten acres of picnic sites complete with two restrooms and five covered shelters. Shelters are reservable and are available on a first-come, first-served basis at other times. ADA accessible picnic shelter and restroom available.

Group Shelter — A large group shelter with capacity for 150 and equipped

with range, refrigerator, bathrooms, grill, tables and chairs, and outside oyster cooking shed is available for rental from 9:00 a.m. to 9:30 p.m.

Boat Ramp/Fishing Pier — Available outside park entrance within one-half mile of the park on the intracoastal waterway.

Swimming — Nearest swimming is at Butterbean Beach at the boat ramp or at Tybee Island Beach.

Interpretive Center — A giant ground sloth exhibit, birding station and other nature displays are featured in the Interpretive Center. Programs for all ages are offered throughout the year. Typically open Wednesday - Sunday 10:00 a.m. - 5:00 p.m.

Nature Trails — The mile-long Sandpiper Trail (ADA accessible) and the 3-mile Big Ferry Trail wind through saltwater marshes and maritime forests, and both offer boardwalks and observation platforms. Skidaway Island State Park is part of the Colonial Coast Birding Trail, and Painted Buntings are frequently spotted by hikers.

Park Information

Park Hours 7:00 a.m. - 10:00 p.m.
 Office Hours Daily 8:00 a.m. - 8:00 p.m.
 Address 52 Diamond Causeway, Savannah, GA 31411
 Location Six miles southeast of Savannah on Diamond Causeway
 County Chatham County
 Park Telephone (912) 598-2300
 Interpretive Center (912) 598-2301
Reservations..... www.GaStateParks.org or 1-800-864-7275
 Website..... www.GaStateParks.org
 E-Mail skidaway.park@gadnr.org

In Case of Emergency

Pay telephones are located at the turn-around in front of the Interpretive Center. Park staff residences are indicated on the map.

Park Emergency Phone (912) 598-2300

After 8:00 p.m. check office door for ranger on duty.

Hospital, E.M.S., Police, Fire 911

To get to the nearest hospital/emergency service, turn right out of the park gate, cross both bridges to a traffic light. Go straight ahead for eight miles. Memorial Medical Center will be on the right, 4700 Waters Ave.

ParkPass - A parking fee is required at all state parks. Frequent visitors can save money with an Annual ParkPass. Join the *Friends of Georgia State Parks* and get a **free** Annual ParkPass. The daily ParkPass is valid at all state parks visited that day.

Nearby Attractions

- Wormsloe State Historic Site (Colonial Tabby Ruins)
- Fort McAllister State Historic Park (Civil War Museum)
- Fort Morris State Historic Site (1770s History)
- Oatland Island
- Mighty Eighth Museum
- UGA Aquarium
- Historic Savannah
- Tybee Island Beach
- Ships of the Sea Maritime Museum

Operated by the Georgia Department of Natural Resources,
 2600 Highway 155, Stockbridge, GA 30281
 (770) 389-7277, www.GaStateParks.org.

Legend

-  Campground Host
-  30 Amp Campsite
-  50 Amp Campsite
-  50 Amp Sewer
-  Camper Cabins
-  Restrooms
-  Showers
-  Laundry
-  Dump Station
-  Handicap
-  Parking
-  Picnic Shelter
-  Playground
-  Camping
-  Dumpsters
-  Trails

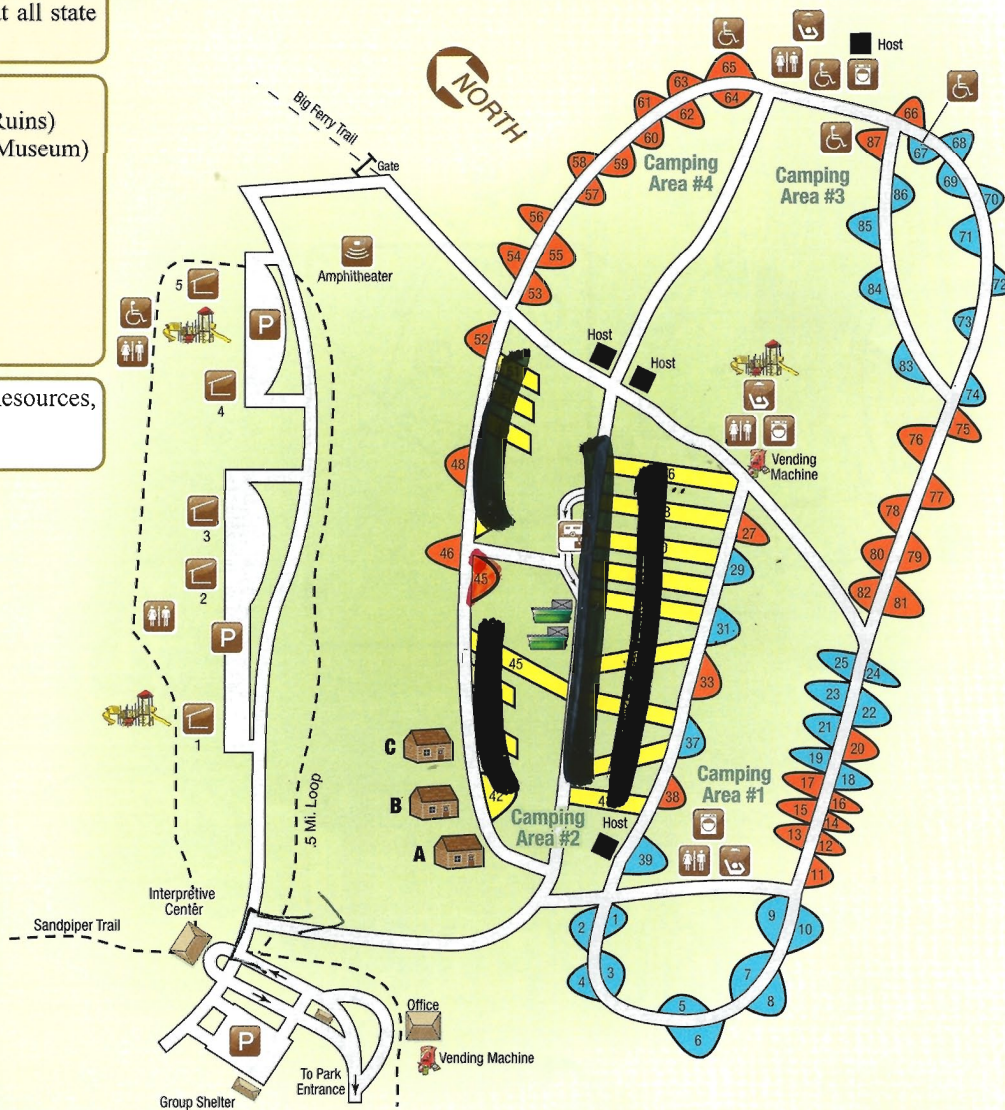



SKIDAWAY ISLAND STATE PARK

Park Rules and Regulations

Pets: Pets are welcome as long as they are kept on a leash (no longer than 6 feet), accompanied by their owner at all times and cleaned up after. Pets are not permitted in Camper Cabins or Group Shelter.

Intoxicants: Consumption or use of alcoholic beverages or intoxicants is unlawful in any public use area. This means the only places alcohol is permitted is inside your camping unit (tent, RV, or motor home), inside our rental facility the Group Shelter, or inside one of our Camper Cabins. Alcohol is not permitted in the Pioneer Campground or Picnic Shelters.

Campfires: All campfires must be kept in the fire ring, attended at all times, and out before retiring for the night.

Weapons: Bows and arrows, explosives, fireworks, slingshots, fishing spears, or any device that discharges projectiles by any means is prohibited. Firearms must be unloaded, cased and stored, unless a person possesses a license to carry a concealed firearm that is valid in this state. A person possessing a license to carry a concealed firearm that is valid in this state may carry such firearm on Skidaway Island State Park.

Collecting: All wildlife, plant life, driftwood, artifacts, and any other natural or man-made features are protected and may not be disturbed or removed. Please leave wildflowers for others to enjoy. Use of electronic devices for "treasure hunting" is prohibited. This includes foraging and/or collecting down and dead wood for firewood.

Motor Vehicles: Park roads are public roads. All vehicles are subject to license and safety requirements and regulations of the Georgia Department of Public Safety. ATVs are not allowed in State Parks. Washing vehicles including motor homes or RV's is not permitted.

Noise Levels: Please be considerate of guests who are visiting state parks for a quiet, natural experience. Radios, televisions, musical instruments, and all other noise making devices are not to be used between 10:00 p.m. and 7:00 a.m. and must be kept at low volumes during other times.

Visitors: Visitors to campsites are welcome; however the number of visitors and registered guests must not exceed the stated capacity at any time. Visitors must leave prior to closing times. Visitor's vehicles must display a Georgia State Park Pass in their vehicle while on the park.

Group Activities: All group gatherings must conclude before 10:00 p.m.

Bicycles: Bicycles are permitted on the Big Ferry Trail and all roads in the park. Georgia State Law requires all persons under the age of 16 to wear a bicycle helmet.



SKIDAWAY ISLAND STATE PARK

Hours of Operation: Park office 8am – 8pm, Interpretive Center 10am – 5pm, Wednesday - Sunday
Park Gate Opens at 7am and closes at 10 pm daily

Campsite Regulations

Dump Station: Unless you have a sewer hookup site, all **gray** and black water has to be dumped in the dump station located at the center of the campground.

Campsite Occupancy: To protect park resources, campsite occupancy is limited to one of the following combinations:

- One motor home, two additional automobiles, and one tent
- One automobile with pop-up trailer/travel trailer, one additional automobile and one tent
- One pick-up truck with mounted camping rig, two additional automobiles, and one tent
- Two tents and two automobiles

One boat trailer is also allowed at each site provided that the site is large enough. Campsites have a **six-person occupancy limit**, and tents must fit on designated tent pads. Tents erected off designated tent pads are subject to removal. Camping between designated sites is prohibited. When camping areas are filled to stated capacity, no other campers will be allowed. Camping is limited to 14 consecutive days at any one park. Visitors using a campsite for 14 nights must vacate the park for at least four nights before returning.

Check in/Check out: Check-in is between 1 and 10 p.m. and checkout is before 1 p.m. Office is open from 8 a.m. until 8 p.m., if you plan on arriving after 8 p.m. check the office door for step by step instructions of what to do. For Check out, you do not have to check out at the office, just remove your reservation tag from the post and head out.

Camper Cabin Regulations

Pets: Pets are not permitted in Camper Cabins. If you are found with a pet during or after your stay, you will be charged a fee at the discretion of the Park Manager.

Camper Cabin Occupancy:

- Cabin B has a 4 person limit. Cabins A & C have a 5 person limit. We will allow up to 6 people per cabin in certain cases with prior approval from the Park Manager.
- One boat trailer is also allowed at each site provided that the site is large enough.
- No tents or additional camping units are permitted at the camper cabin sites.

Damages: You are responsible for any damages that occur during your stay.

Check in/Check out: Check-in is between 4 and 8 p.m. and checkout is before 11 a.m. If you are arriving after 8 p.m. please call the park office to see if arrangements can be made to pick up the key. To check out please come by the office and drop off your key.